

DATENBLATT / DATASHEET



Specification: QTCC-UM5SMD

Crystal unit: UM-5 SMD

Date: 11.03.2009  
ROHS compliance

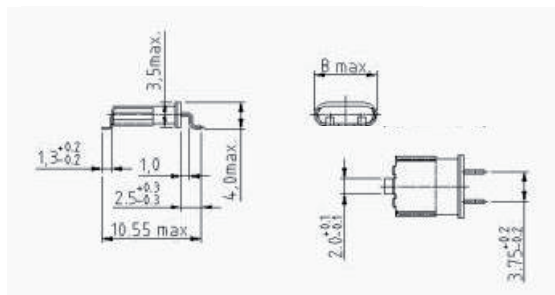

TABLE 1

10 ... 160 MHz		UNIT	CONDITION
Frequency range	10 - 160	MHz	
Crystal cut	AT		
Enclosure	UM-5-SMD		
Mode	10 – 45 MHz 30 – 150 MHz 100 – 160 MHz		Fundamental mode 3 <sup>rd</sup> overtone 5 <sup>th</sup> overtone
Load capacitance	10 – 50 pF or Series	pF	
Shunt capacitance	7 pF max.	pF	
Motional capacitance			
Resistance R <sub>R</sub>			see table 2
Frequency adjustment at +25°C	± 10 to ± 100	ppm	
Frequency stability over temperature	- 20 to +70°C: ± 10 to ± 100 - 40 to +85°C: ± 20 to ± 100 - 40 to +105°C: ± 30 to ± 100	ppm	
Aging 1 <sup>st</sup> year	± 3	ppm	
Drive level	0,1	mW	
Packing	Bulk / Tape & reel		

TABLE 2

MAX. RESISTANCE R <sub>R</sub>	MODE	FREQUENCY / MHz	R <sub>MAX</sub> / Ohm
	1	10,0 – 17,9	40
		18,0 – 45,0	30
	3	30,0 – 49,9	50
		50,0 – 100,0	40
	5	100,0 – 160,0	120