

DATENBLATT / DATASHEET



Specification: QTCC-7x5

Crystal unit: 7 x 5 SMD

Date: 10.02.2009  
ROHS compliance

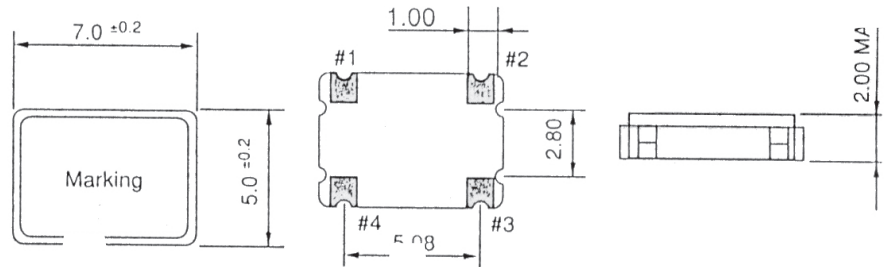

TABLE 1

8 ... 80 MHz		UNIT	CONDITION
Frequency range	8 - 86	MHz	
Crystal cut	AT		
Enclosure	7 x 5 SMD		
Mode	8 - 40 MHz 30 - 80 MHz		Fundamental mode 3 <sup>rd</sup> overtone
Load capacitance	5 - 50 pF or Series	pF	
Shunt capacitance	7 pF max.	pF	
Motional capacitance			
Resistance $R_R$			see Table 2
Frequency adjustment at +25°C	$\pm 10$ to $\pm 100$	ppm	
Frequency stability over temperature	- 20 to +70°C: $\pm 10$ to $\pm 100$ - 40 to +85°C: $\pm 20$ to $\pm 100$ - 40 to +105°C: $\pm 30$ to $\pm 100$	ppm	
Aging 1 <sup>st</sup> year	$\pm 3$	ppm	
Drive level	0,1	mW	
Packing	Bulk / Tape & reel		

TABLE 2

MAX. RESISTANCE $R_R$	MODE	FREQUENCY / MHz	$R_{RMAX}$ / Ohm
	1	8,0 - 9,0	150
		9,0 - 10,9	120
		11,0 - 17,9	50
		18,0 - 40,0	30
	3	30 - 80,0	80